



ARROW
SUSPENSION

OWL INSTALL GUIDE

2015-UP MERCEDES SPRINTER 4X4, AWD COMPOUND DOUBLE SHEAR KIT SP-CMPD-2500

UPDATED FALL 2025

NOTES

For the most up-to-date and current installation instructions, please visit our website at **www.owlvans.com**

- Please read all instructions carefully before installing Owl products on your vehicle.
- This is a bolt-on shock bracket kit designed for easy installation using basic hand tools.
- This shock kit is fully removable, allowing the vehicle to be returned to its original stock configuration if desired.
- This bolt-on bracket system installs with standard hand tools. No welding required. Two small holes are drilled for the forward attachment point.
- The kit is designed specifically around Owl-tuned Falcon shock setups for a precise fit and proper alignment.

ABOUT THE COMPOUND SERIES

Every Owl component is engineered for one purpose: to perform flawlessly in the real world. The Compound Double Shear Bracket reinforces the upper shock mount for extreme terrain and heavy-duty use, transforming the Sprinter's rear suspension into a more controlled, confident system under load. Designed and manufactured in the USA, this bracket is part of Owl's Arrow Suspension Series—precision parts built to stand up to the demands of adventure.

PARTS LIST

2007-Up, Mercedes Sprinter 4x4, AWD DOUBLE SHEAR BRACKET
SP-UCMPD-2500

PART	P/N	QTY.	✓
REAR UPPER SHOCK MOUNT- DRIVER	SP-2500-RUSM-D	1	
REAR UPPER SHOCK MOUNT-PASSENGER	SP-2500-RUSM-P	1	
SPRINTER REAR UPPER SHOCK MOUNT BOSS	SP-2500-RUSM-04	2	
FRONT SPACER PLATE	SP-SHK-SPR	4	
SPRINTER 2500 RUSM LOCKING BOLT PLATE	SP-2500-RUSM-02	2	
M14 X 160MM BOLT, GRADE 10.9		2	
M14 STOVER NUT		2	
M14 WASHER		6	
M14 X 100MM BOLT, FINE THREAD		2	
M10 X 25MM BOLT, GRADE 10.9		6	
M10 NYLOCK NUT		6	
M10 WASHER		14	
STAINLESS SHOCK SPACER (.284" W X .570" ID)	SP-RUSM-SPCR	2	

TOOLS NEEDED

1. Quality jack and two jack stands
2. Basic hand tools:
 - Wrench and socket set, including:
 - Metric sizes: 17mm, 18mm, 19mm, 21mm, 22mm
3. Torque wrench
4. Drill equipped with a 27/64" (10.8mm) metal-cutting drill bit
5. Hammer and chisel

INSTALLATION

These instructions show installation on the driver's (left-hand) side. Passenger side installation is similar; any differences will be noted in the steps.

1.

Loosen lug bolts then safely support the vehicle on an appropriate lift or jack stands so the rear suspension can hang freely. Ensure the support method follows the vehicle manufacturer's specifications.

2.

With the suspension supported, remove the front wheels and tires. Factory lug bolts typically have a 19mm head.

3.

Remove Factory Shocks - Remove the OEM shocks using 18mm (lower) and 21mm (upper) sockets. Retain the lower bolts.

4.

Prepare the Mounting Area - Clean undercoating from upper corner area of the shock mount.

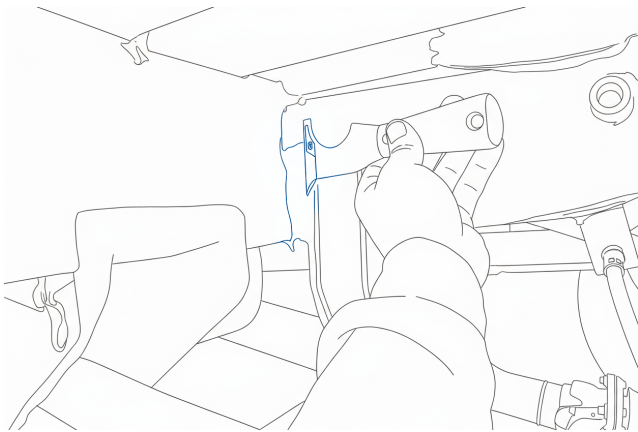

5.

Install Upper shock mount boss - Insert supplied shock spacer bung into the bracket. Confirm orientation.

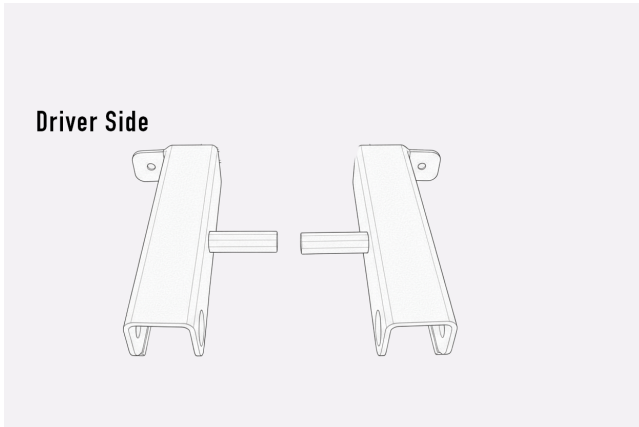
**6.**

Test Fit the Bracket - Fit bracket to chassis. Ensure it sits flush.

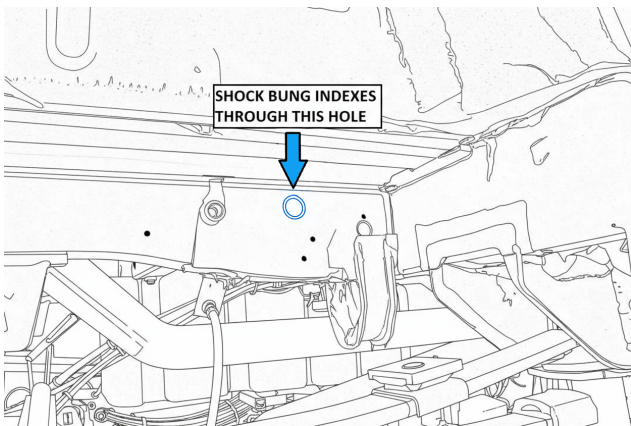
**7.**

Start Upper Shock Bolt - Install M14 x 100mm bolt with washer, snug lightly.

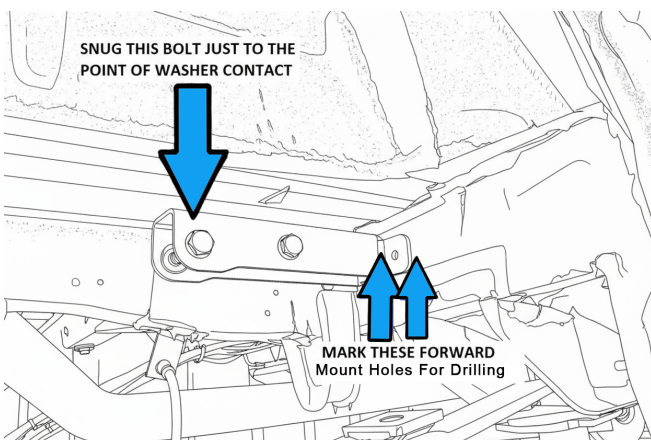

8.

Mark Forward Mounting Holes - Mark two front holes for drilling.

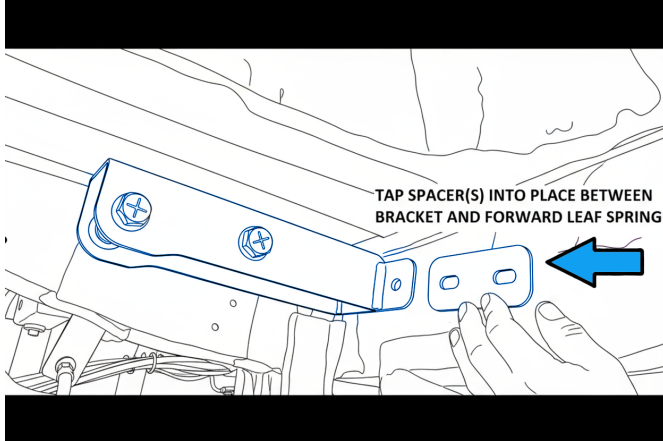
**9.**

Drill Forward Holes - Remove bracket and drill with 10.8mm bit. Paint exposed metal.

10.

Install Spacer Plates - Reinstall bracket, tap one spacer plate between bracket and crossmember.

11.

Install Forward Bolts - Install M10 x 25mm bolts with washers, hand-tighten.

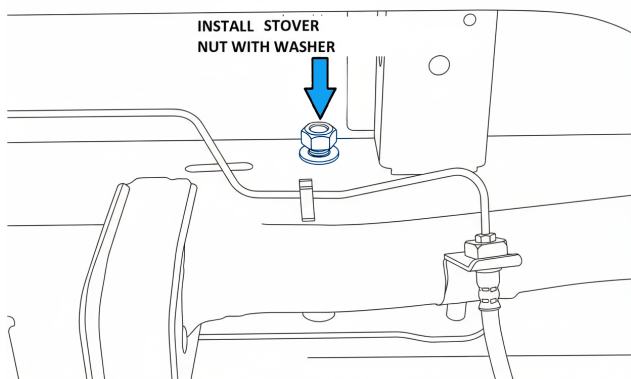

12.

Install Main Bolt Through Spacer Bung - Insert M14 x 160mm bolt through bung and chassis, snug.

13.

Shock Orientation - Offset bushing toward inside. If none, use stainless spacer between shock and chassis.

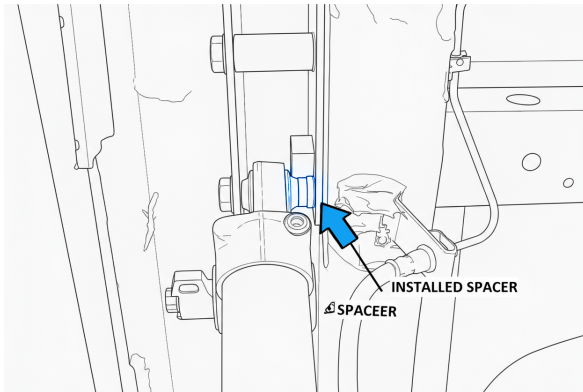
**14.**

Install Upper Shock Bolt - Apply red Loctite, snug using 22mm socket until washer cannot spin.

15.

Torque All Hardware - Shock Bung Bolt: 100 ft-lbs, Upper Shock Bolt: 100 ft-lbs, Forward Bolts: 42 ft-lbs.

16.

Install Lower Shock Bolt - Reinstall OEM lower bolt and torque to 80 ft-lbs.

17.

Install Locking Bolt Plate - Use one washer under bolt head, one between tab and bracket, one under nut. Torque to 42 ft-lbs.

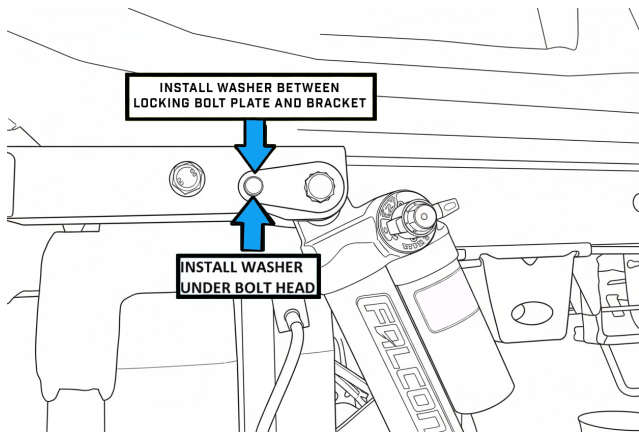
**18.**

Reinstall wheels/tires. Torque wheel studs per OEM spec:

- 2500 SRW: 170 ft-lbs (231 N·m)
- 3500 DRW: 140-150 ft-lbs (190-200 N·m)
- Owl Wheels: 135ft-lbs (183.1 N·m)

19.

Check shock clearance after lowering the vehicle.

20.

After 100 miles, recheck bolt torques.

CONGRATS!

YOUR INSTALLATION IS COMPLETE.

RELEASE OF LIABILITY

I, the customer, do hereby release and forever discharge Owl Vans LLC, their agents, employees, successors and assigns, and their respective heirs, personal representatives, affiliates, successors and assigns, and any and all persons, firms or corporations liable or who might be claimed to be liable, whether or not herein named, from any and all claims, demands, damages, actions, causes of action or suits of any kind or nature whatsoever, whether known or unknown, fixed or contingent, which I now have or may hereafter have or claim to have, as a result of or in any way relating to the following: Parts sold & installed by Owl Vans LLC or parts sold & installed by end-user; any parts sold online, any parts sold online or installed by a re-seller, any parts installed by an installation shop.

It is understood and agreed that this payment is made and received in full and complete settlement and satisfaction of the aforesaid actions, causes of action, claims and demands; that this Release contains the entire agreement between the parties; and that the terms of this Agreement are contractual and not merely a recital.

Furthermore, this Release shall be binding upon the undersigned, and his respective heirs, executors, administrators, personal representatives, successors and assigns. This Release shall be subject to and governed by the laws of the State of Idaho.

PRODUCT SAFETY WARNING:

Owl Vans LLC strongly recommends the installation of products be done by a certified mechanic. If this does not occur, be certain the person(s) installing the product read, understand and follow all instructions and warnings pertaining to the application before installation. Do not add, alter, or fabricate any factory or aftermarket parts to increase vehicle height over the intended height of the Owl Vans LLC product purchased. Mixing component brands is not recommended.

Installation of suspension lift kits or any other lifting kits or devices will raise the center of gravity. For this reason, Owl Vans LLC urges that extreme caution be used when encountering driving conditions which may cause vehicle imbalance. Furthermore, the driver's field of vision and judgment will not be as good due to the height of the vehicle. Due to the installation of larger tires, the speedometer will read slower than the actual speed being traveled and more distance will be required to stop the vehicle. It is the owner's responsibility to caution and warn any potential driver of the vehicle about these driving and handling conditions. Owl Vans LLC will not be held liable or responsible for damages or personal injuries resulting from the use of lifting devices and or related products. The tires and rims should be changed to sufficiently increase the vehicle's total overall width and stability to help accommodate lifting devices.

Owl Vans LLC aftermarket suspension products and accessories modify a vehicle for uses which exceed conditions anticipated by the vehicle manufacturer. The uses include the high performance demands required during off-road. These conditions vary in the degree of extremity and cannot be controlled by the vehicle or product manufacturer. If the components within the suspension system or accessories become worn due to frequent and/or extreme use, the safety and reliability of the vehicle is at risk. The maintenance of aftermarket equipment to ensure the vehicle occupants safety is entirely your responsibility. Do not purchase Owl Vans LLC products unless you are willing to accept this responsibility. Do not install any Owl Vans LLC suspension products or accessories unless you feel competent at installing the product without causing present or future injury to yourself or other vehicle occupants; seek an authorized installation center.

Most states have some type of law limiting vehicle height. The amount of lift allowed, and how the lift can be achieved, varies greatly. Several states offer exemptions for farm and commercial registered vehicles. It is the vehicle owner's responsibility to check state and local laws to ensure that their vehicle will be in compliance.

Owl Vans LLC reserves the right to make changes in design, materials and specifications as deemed necessary without prior notice and without assuming obligation to modify any product previously manufactured. Obligation or liabilities will not be assumed with respect to similar products previously advertised.

This Release of Liability and Product Safety Warning has been read and fully understood by the undersigned and has been explained to me.