



**ARROW**  
**SUSPENSION**

OWL INSTALL GUIDE

# **2015-UP MERCEDES SPRINTER AWD PRO SERIES BUMP STOP BRACKETS**

UPDATED FALL 2025

# NOTES

For the most up-to-date and current installation instructions, please visit our website at **[www.owlvans.com](http://www.owlvans.com)**

- Please read all instructions carefully before installing Owl products on your vehicle.
- This is a bolt-on kit designed for easy installation using basic hand tools.
- This shock kit is fully removable, allowing the vehicle to be returned to its original stock configuration if desired.

# PARTS LIST

## 2015-Up, Mercedes Sprinter AWD Front Bump Stop Bracket

PART	P/N	QTY.	✓
MERCEDES SPRINTER VS30 AWD FRONT DRIVER BUMP STOP BRACKET	SP-FBSB-D	1	
MERCEDES SPRINTER VS30 AWD FRONT PASSENGER BUMP STOP BRACKET	SP-FBSB-P	1	
FRONT BUMP STOPS	SP-FBS	2	
10.9 M8-1.25 X 25MM HEX HEAD,FLANGE BOLTS GR10.9		2	

# TOOLS NEEDED

1. Quality jack and two jack stands
2. Basic hand tools:
  - Wrench and socket set, including:
  - Metric sizes: 13mm, 16mm, 17mm

# INSTALLATION

These instructions show installation on the driver's (left-hand) side. Passenger side installation is similar; any differences will be noted in the steps.

## 1.

Loosen lug bolts then safely support the vehicle on an appropriate lift or jack stands so the rear suspension can hang freely. Ensure the support method follows the vehicle manufacturer's specifications.

## 2.

With the suspension supported, remove the front wheels and tires. Factory lug bolts typically have a 19mm head.

## 3.

Locate the OEM bump stop and remove the M8 nut securing it to the bump stop mount using a 13mm socket or wrench. Once the nut is removed, remove the bump stop or aftermarket jounce from the vehicle.

## 4.

Locate and remove the M10 bolts securing the OEM front gusset bracket to the lower control arm.

- **2015-2022 4x4 chassis:** Three (3) bolts secure the bracket.
- **2023+ AWD chassis:** Four (4) bolts secure the bracket.  
After removal, **retain all OEM hardware**, as it will be **reused during reinstallation**.  
*See image below for reference.*

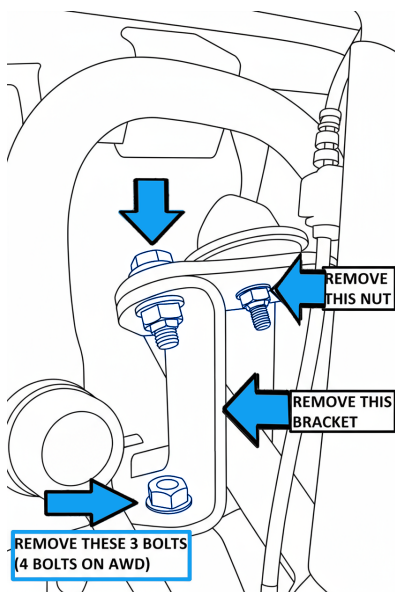

**5.**

Position the **new Owl Front Bump Stop Brackets** in the **same mounting location** as the OEM gusset brackets removed in the previous step. The brackets are **side-specific** and will **only install in one orientation**.

Refer to the **photo below** for correct positioning and alignment.

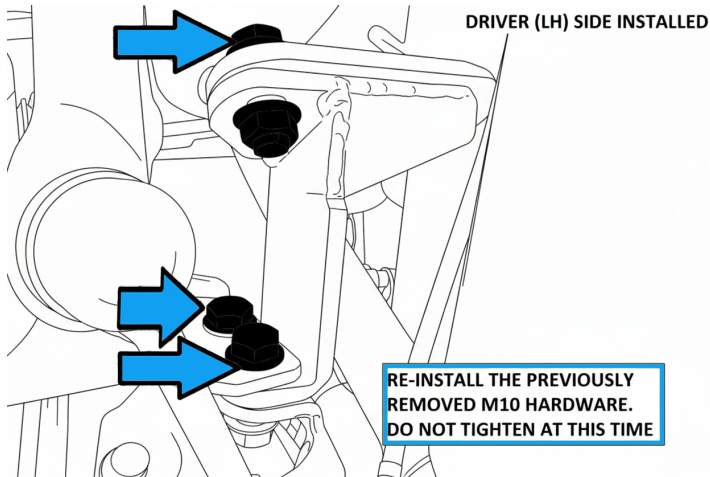
**6.**

Reinstall the OEM M10 hardware into the same mounting locations used previously.

Start all bolts by hand, but **do not fully tighten at this stage** – leave the hardware **loose** to allow for proper bracket alignment during final installation.

**7.**

Insert the **included M8-1.25 x 25mm bolt** into the **outer hole** used for the **bump stop or jounce mount**. This bolt is placed **temporarily** to help **maintain proper alignment** of the jounce mounting hole during installation.

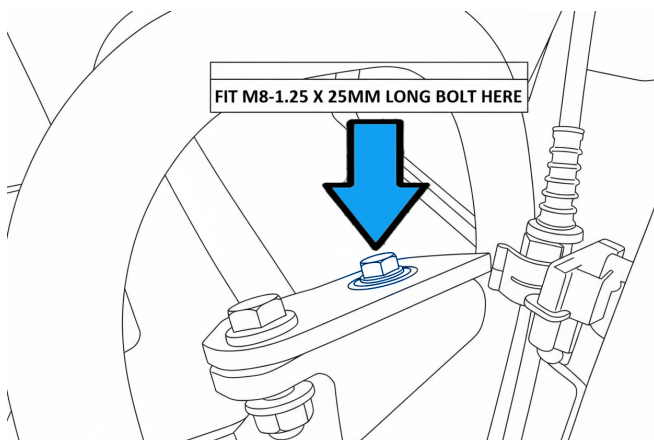

**8.**

With the **M8 alignment bolt** in place, **snug all M10 hardware** to hold the **Owl Front Bump Stop Brackets** securely in position. Do not fully torque at this time—final tightening will occur once all components are aligned.

**9.**

With the **M10 hardware snug**, reinstall the **Owl Bump Stop**. Torque all hardware to the following specifications:

- **M10 hardware:** 43 ft-lbs (58 N·m)
- **M8 jounce nut:** 15 ft-lbs (20 N·m)

**Note:** On **AWD models**, it may be easier to reinstall **taller aftermarket jounces** with the **wheels reinstalled** and the **suspension slightly compressed** from full droop.

If installing an **Owl Bump Stop** use the **included M8-1.25 x 25mm bolt** from this kit for reattachment.

**10.**

Repeat the **installation process on the passenger side** of the vehicle if it has not already been completed. Ensure all hardware is torqued to specification and components are properly aligned before final inspection.

**11.**

Reinstall the **wheels and tires**, then **torque all lug bolts or nuts** to the **wheel manufacturer's specifications**. Verify proper wheel seating and ensure all fasteners are evenly torqued in a star pattern.

**12.**

After 100 miles, recheck bolt torques.

# CONGRATS! YOUR INSTALLATION IS COMPLETE.

**RELEASE OF LIABILITY**

I, the customer, do hereby release and forever discharge Owl Vans LLC, their agents, employees, successors and assigns, and their respective heirs, personal representatives, affiliates, successors and assigns, and any and all persons, firms or corporations liable or who might be claimed to be liable, whether or not herein named, from any and all claims, demands, damages, actions, causes of action or suits of any kind or nature whatsoever, whether known or unknown, fixed or contingent, which I now have or may hereafter have or claim to have, as a result of or in any way relating to the following: Parts sold & installed by Owl Vans LLC or parts sold & installed by end-user; any parts sold online, any parts sold online or installed by a re-seller, any parts installed by an installation shop.

It is understood and agreed that this payment is made and received in full and complete settlement and satisfaction of the aforesaid actions, causes of action, claims and demands; that this Release contains the entire agreement between the parties; and that the terms of this Agreement are contractual and not merely a recital.

Furthermore, this Release shall be binding upon the undersigned, and his respective heirs, executors, administrators, personal representatives, successors and assigns. This Release shall be subject to and governed by the laws of the State of Idaho.

**PRODUCT SAFETY WARNING:**

Owl Vans LLC strongly recommends the installation of products be done by a certified mechanic. If this does not occur, be certain the person(s) installing the product read, understand and follow all instructions and warnings pertaining to the application before installation. Do not add, alter, or fabricate any factory or aftermarket parts to increase vehicle height over the intended height of the Owl Vans LLC product purchased. Mixing component brands is not recommended.

Installation of suspension lift kits or any other lifting kits or devices will raise the center of gravity. For this reason, Owl Vans LLC urges that extreme caution be used when encountering driving conditions which may cause vehicle imbalance. Furthermore, the driver's field of vision and judgment will not be as good due to the height of the vehicle. Due to the installation of larger tires, the speedometer will read slower than the actual speed being traveled and more distance will be required to stop the vehicle. It is the owner's responsibility to caution and warn any potential driver of the vehicle about these driving and handling conditions. Owl Vans LLC will not be held liable or responsible for damages or personal injuries resulting from the use of lifting devices and or related products. The tires and rims should be changed to sufficiently increase the vehicle's total overall width and stability to help accommodate lifting devices.

Owl Vans LLC aftermarket suspension products and accessories modify a vehicle for uses which exceed conditions anticipated by the vehicle manufacturer. The uses include the high performance demands required during off-road. These conditions vary in the degree of extremity and cannot be controlled by the vehicle or product manufacturer. If the components within the suspension system or accessories become worn due to frequent and/or extreme use, the safety and reliability of the vehicle is at risk. The maintenance of aftermarket equipment to ensure the vehicle occupants safety is entirely your responsibility. Do not purchase Owl Vans LLC products unless you are willing to accept this



responsibility. Do not install any Owl Vans LLC suspension products or accessories unless you feel competent at installing the product without causing present or future injury to yourself or other vehicle occupants; seek an authorized installation center.

Most states have some type of law limiting vehicle height. The amount of lift allowed, and how the lift can be achieved, varies greatly. Several states offer exemptions for farm and commercial registered vehicles. It is the vehicle owner's responsibility to check state and local laws to ensure that their vehicle will be in compliance.

Owl Vans LLC reserves the right to make changes in design, materials and specifications as deemed necessary without prior notice and without assuming obligation to modify any product previously manufactured. Obligation or liabilities will not be assumed with respect to similar products previously advertised.

This Release of Liability and Product Safety Warning has been read and fully understood by the undersigned and has been explained to me.